



## Lars 3-in-1 Highchair Instruction manual



# IMPORTANT! READ CAREFULLY AND KEEP FOR FUTURE REFERENCE

Highchair and booster: Suitable for children who are able to sit up unaided (approximately 6-9 months) up to 36 months and not exceeding 15kg/33lbs. Your child's safety may be affected if you do not follow these instructions.

EN14988:2017+A1:2020 / EN16120:2012+A2:2016

## Safety instructions

We know that safety is of utmost concern for parents and carers of children. Whilst this product has been developed to all of the relevant safety standards, we need your help to maintain that level of safety and minimise the risk of a baby using this product being harmed. Your baby should never be left alone in the highchair and all harmful objects should be kept out of your child's reach.

**Warning:** NEVER leave the child unattended.

**Warning:** Always use the restraint system.

**Warning:** Falling hazard: Prevent your child from climbing on the product.

**Warning:** Do not use the product unless all components are correctly fitted and adjusted. Your child's safety is your responsibility.

**Warning:** Be aware of the risk of open fires and other sources of strong heat, such as electrical bar fires, gas fires etc. in the vicinity of the product.

**Warning:** To avoid injury keep your child away when assembling or adjusting this product.

**Warning:** Ensure the seat-lock screw is attached and correctly tightened before seating a child in the highchair.

**Warning:** The tray is not designed to hold the child in the highchair. ALWAYS use the harness.

**Warning:** Do not allow children to stand on the seat or footrest or climb into or out of the highchair.

**Warning:** When adjusting the tray, ensure that parts of your child's body are clear of any moving parts.

**Warning:** Highchair and booster are suitable for children who are able to sit up unaided (approximately 6-9 months) up to 36 months and not exceeding 15kg/33lbs.

**Warning:** Bar stool (tall stool) is suitable for children aged 5 to 10 years.

- Ensure that the locks and catches on the product are not obstructed at any time during use.
- Do not let your child play with this product.
- Ensure the safety harness is fastened and correctly adjusted at all times.
- Do not use near stairs or steps.
- Ensure the highchair is used on a secure and level surface.
- Never carry the highchair with your baby in it.
- Do not use if any part is broken, torn or missing. Periodically check for loose or damaged parts.
- It is recommended that the highchair is only used by babies who can sit and support themselves unaided.
- Only use parts and accessories approved by the manufacturer. Others may render the highchair unsafe and will invalidate the warranty.
- This highchair is designed to hold 1 child.

## Your 3 year warranty

Whilst we make and test our products to the highest standards of durability there's always a small chance of a hiccup! Our promise is to repair, replace or refund a MyChild product that has an identified manufacturing defect from the date of purchase for a full 3 years thereafter at no extra cost.

However, you must register within 28 days of the date of purchase to receive the full 3 years guarantee!

To receive your full guarantee you can register your product by: visiting <https://mychild.co.uk/pages/warranty> and complete the warranty form, or by telephone on 0161 335 2508.

## Welcome

Thank you for purchasing the MyChild Lars 3 in 1 Highchair. Please read the instructions and warnings carefully before use to ensure safe and satisfactory operation of this product.

Your child's safety is your responsibility. If you have a query with this product or require replacement parts, please contact the MyChild Helpline on 0161 335 2508.

Lay out the parts on a soft level surface and compare to the part/fixings checklist below. Do not discard any packaging until you are sure that you have all the parts.

**WARNING!** Assembly by an adult. Keep away from children until fully assembled. Keep children clear during assembly as pack contains small parts which may present a choking hazard.

# Parts Checklist

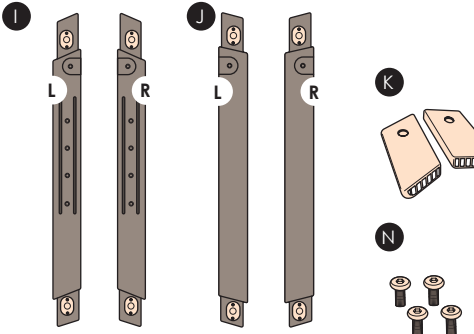
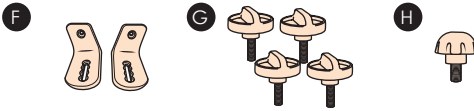
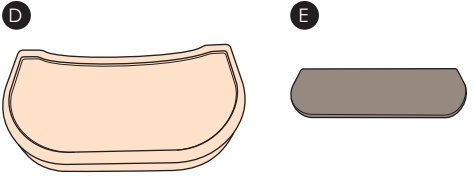
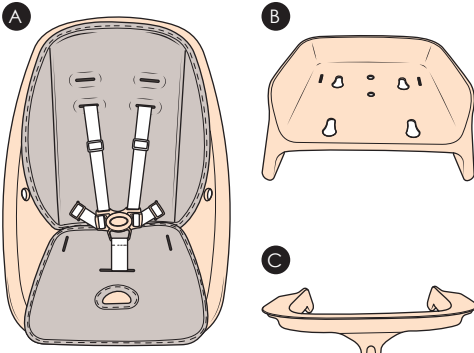

## Contained in your carton are:

N°	Part	Qty
A	Seat shell	1
B	Stool top/seat base	1
C	Armrest	1
D	Tray & snack tray	1
E	Footrest	1
F	Footrest supports	2
G	Footrest screws	4
H	Seat-lock screw	1
I	Front legs	2
J	Rear Legs	2
K	Front Feet	2
L	Rear Feet with crossbar & wheels	1
M	Leg side-braces	2
N	Allen bolts (for side-braces)	4
O	Booster seat feet (plus straps)	4
P	Backrest strap	1
Q	Allen key	1

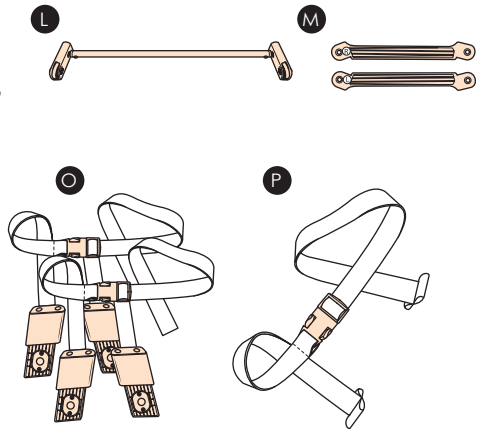

## Assembling the highchair

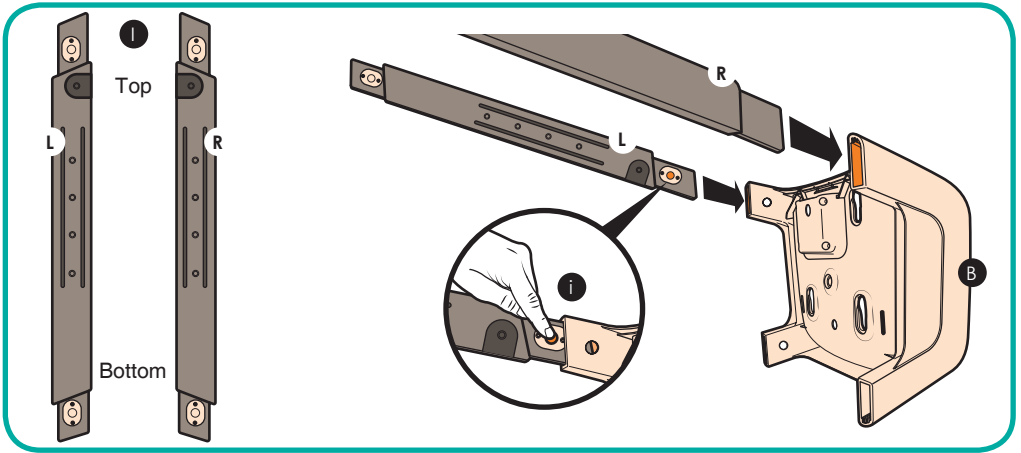

1. Attach the two front legs (I) (legs with long slots) to the stool top (B) as shown. The left leg (L) goes in the front left socket and the right leg (R) in the front right socket. Press in button (i) at the top of each leg and slide the legs into their sockets on the stool top, ensuring the legs 'click' into position.

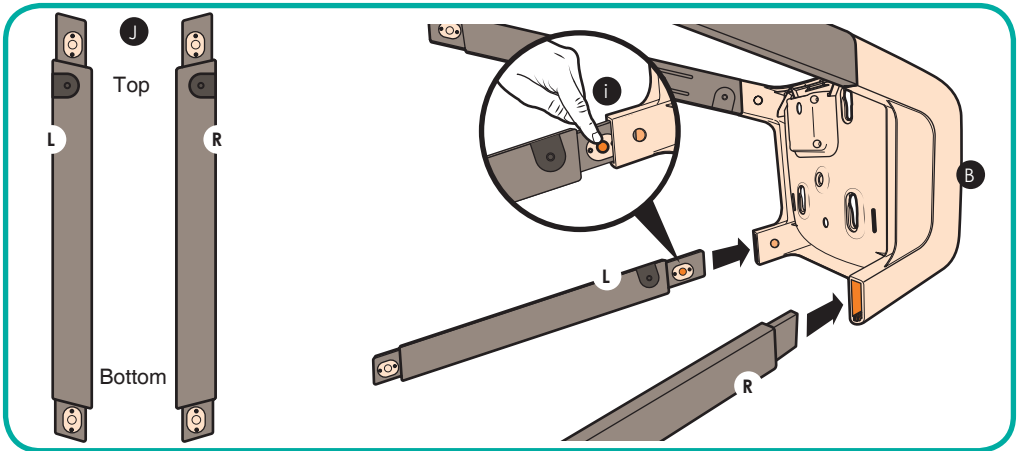

2. Attach the two rear legs (J) (legs with NO slots) to the stool top (B) as shown. The left leg (L) goes in the rear left socket and the right leg (R) in the rear right socket. Press in button (A) at the top of each leg and slide the legs into their sockets on the stool top, ensuring the legs 'click' into position.

## Assembling the highchair (continued)

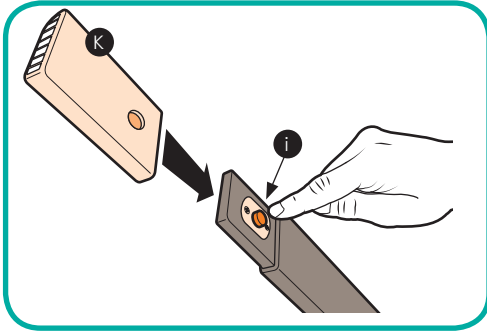

### 3. Attaching the front feet:

Press in button (i) and slide the feet (K) on to the front legs. Ensuring each foot 'clicks' into place.

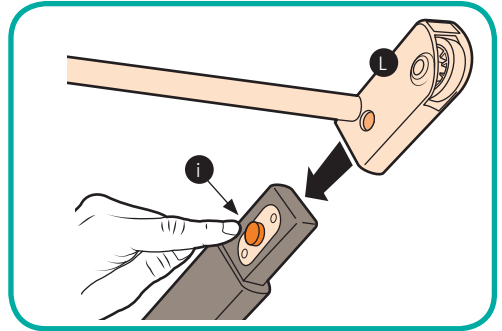

### 4. Attaching the rear feet:

Press in button (i) and slide the feet (L) on to the rear legs. Ensuring each foot 'clicks' into place.

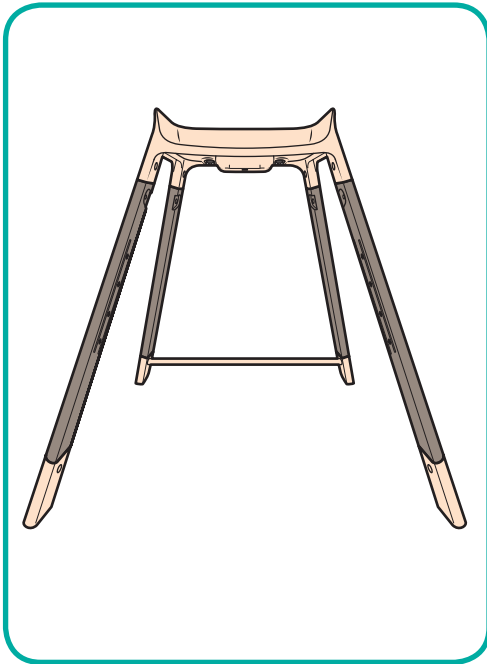

5. You should now have something resembling the image shown above.

**WARNING! The item is still only partly assembled and is not stable. Do not apply ANY weight to the item.**

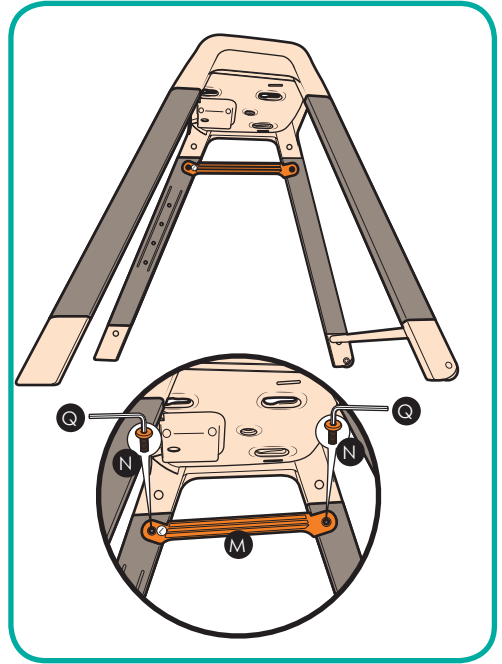

6. Attach leg side-brace (M) using two Allen bolts (N). Tighten the bolts using Allen key (Q). Attach the remaining second leg side-brace in the same way.

## Assembling the highchair (continued)

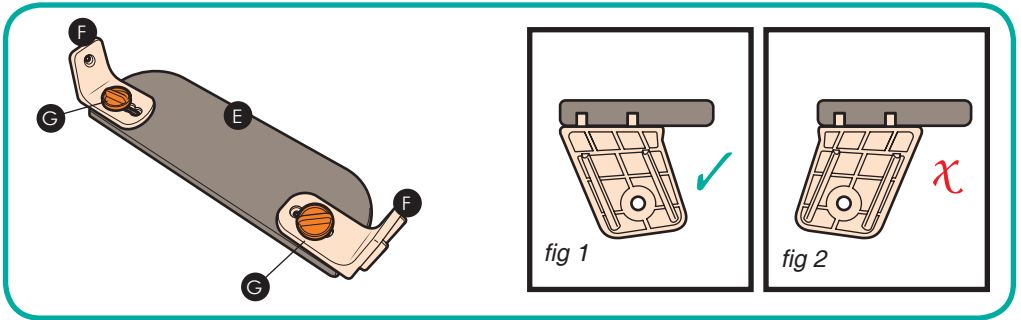

### 7. Assembling the footrest:

Attach the footrest supports (F) to the footrest (E) using two footrest screws (G).

**IMPORTANT:** Check that the assembled footrest and supports resemble (fig 1) when viewed from the side and NOT (fig 2).

**Note:** Move the footrest supports in, towards each other, for the uppermost footrest position and for use with smaller children. Move them outwards, away from each other, for the lowermost footrest position and for use with taller children.

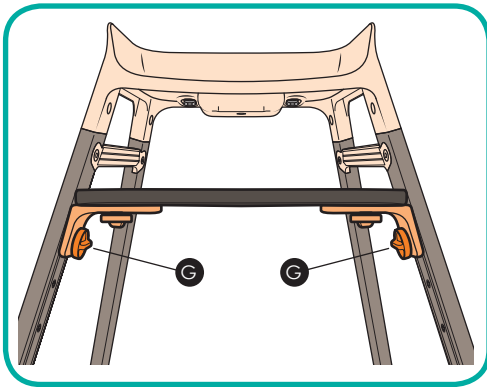

### 8. Attaching the footrest:

Place the assembled footrest between the highchair's front legs and secure using two footrest screws (G).

**Note:** The footrest has four height position settings. Use the uppermost setting for smaller children and lower the footrest when the child outgrows the height setting.

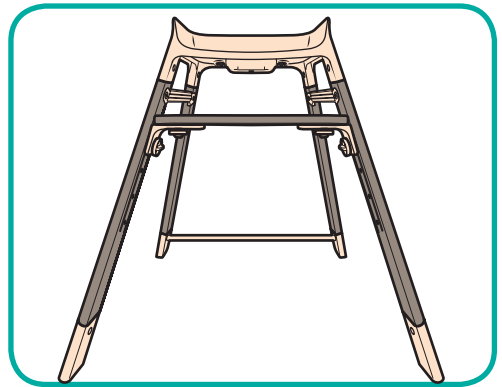

9. You should now have an assembled, and ready to use bar stool, suitable for children aged 5 to 10 years.

Continue with remaining steps to assemble the complete highchair for children aged 6 months to 3 years.

## Assembling the highchair (continued)

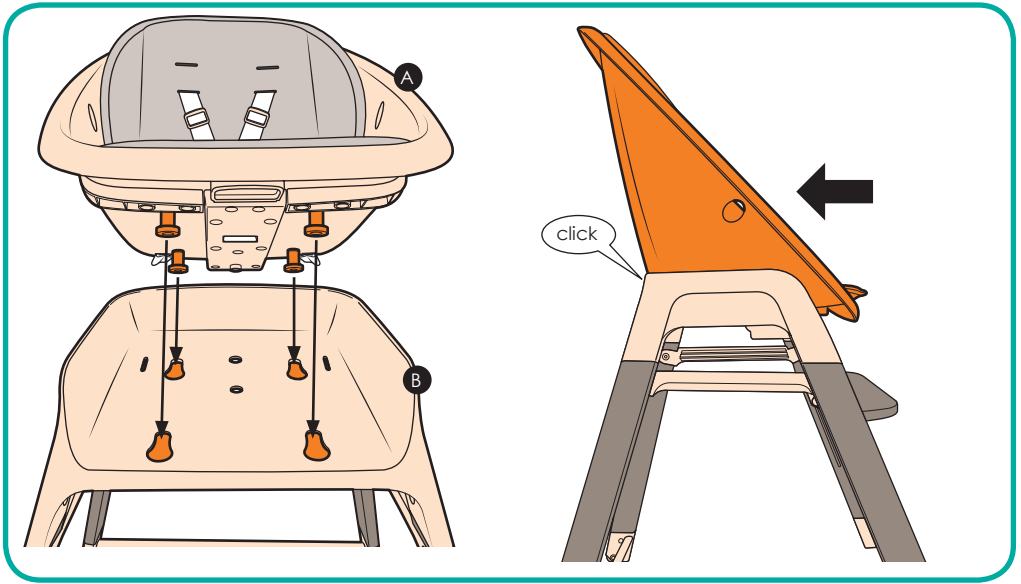

### 10. Attaching the highchair seat:

Insert the four pins on the underside of the seat shell (A) into the four keyhole slots on the upper surface of the stool top (B) and push the seat back into the stool top to lock the four pins in place.

11. Secure the seat (A) to the stool top (B) using the seat-lock screw (H).

**To remove the seat:** Unscrew seat-lock screw (H), press release button (i) and slide the seat back off from the stool top.

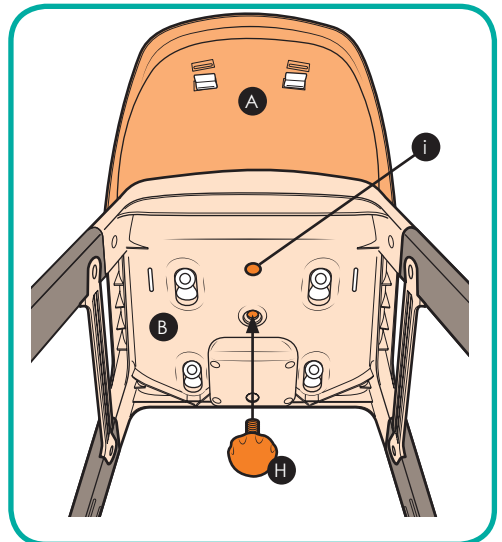



## Assembling the highchair (continued)

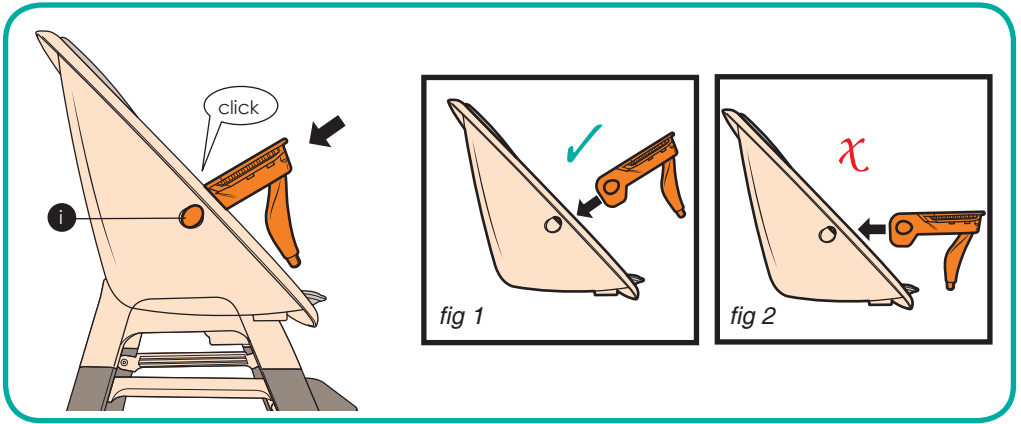

### 12. Attaching the armrest:

Hold the armrest (C) at an angle as shown and insert the armrest so that the buttons (i) insert into the oval holes on each side of the seat.

13. Check the buttons on each side of the armrest are inserted and push them in if not.

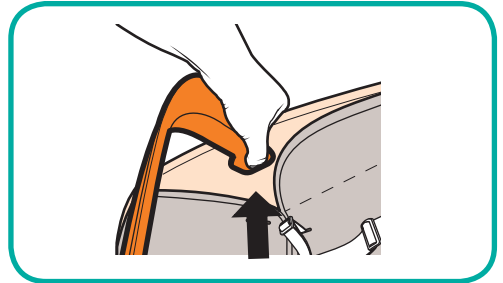

14. Whilst pulling the lever on the front-underside of the seat, push the armrest down so that it locks into the seat.

**IMPORTANT!** Always keep the armrest attached and fixed in position whilst using in the highchair mode.

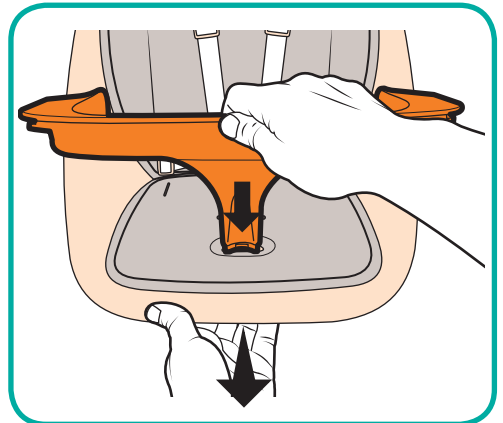

## Assembling the highchair (continued)

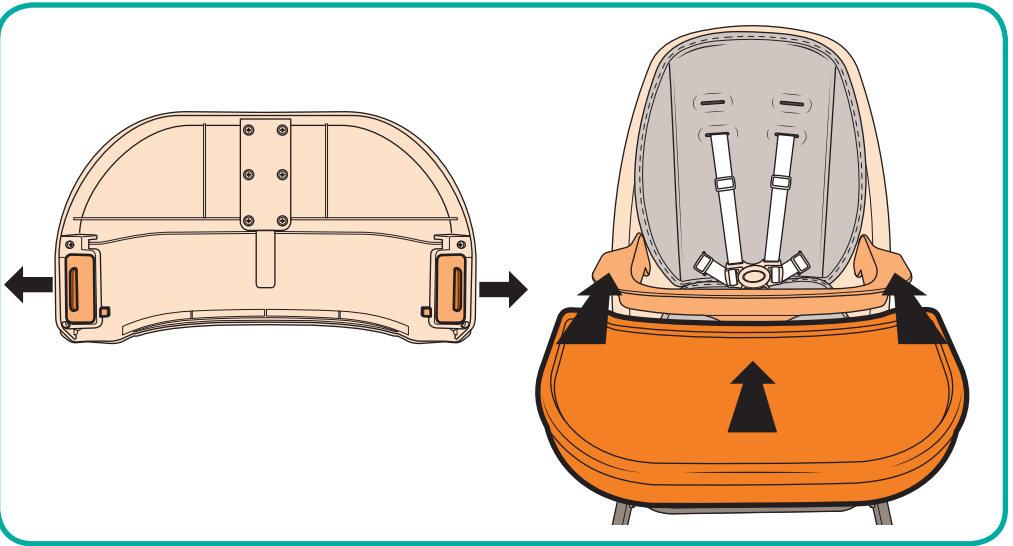

### 15. Attaching the tray and snack tray.

Whilst pulling the two levers on the underside of the tray outwards, place the tray onto the armrest and slide the tray along into position. The tray will click into place when properly located.

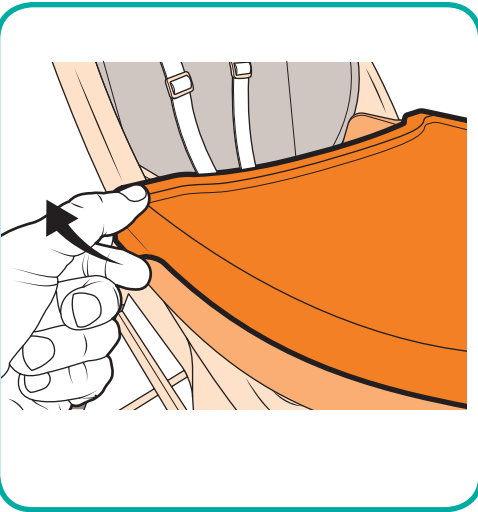

16. The removable snack tray can be removed by levering the tray with your finger as shown. To reattach: simply click it back on.



17. The highchair is now fully assembled.

## Securing your child using the harness

**WARNING:** Always use the five-point harness.

**WARNING:** When using the highchair at a table ensure the child cannot push against the table or any other surface as this could result in the highchair tipping over.

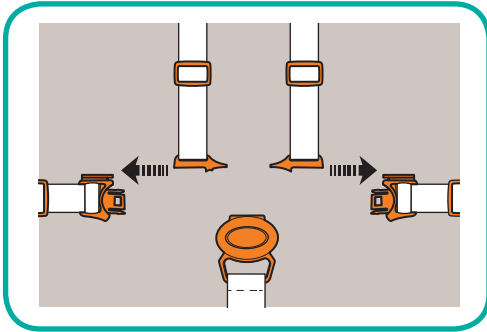

1. Place the crotch strap between your child's legs and slide the shoulder strap clips onto the waist strap clips.

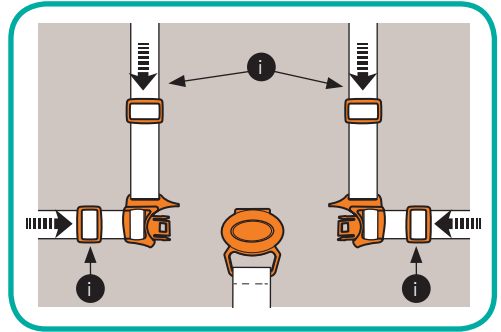

2. Insert the harness clips into the buckle, making certain your child's fingers are clear. Adjust the sliders (i) on the waist and shoulder straps so that the harness fits snugly.

### 3. Releasing the 5-point harness:

Press the harness release button (ii) and slide the buckle sections apart.

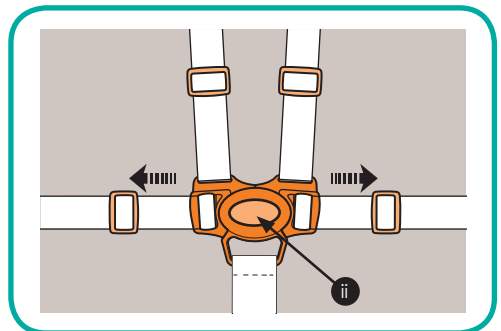

## Assembling the booster seat

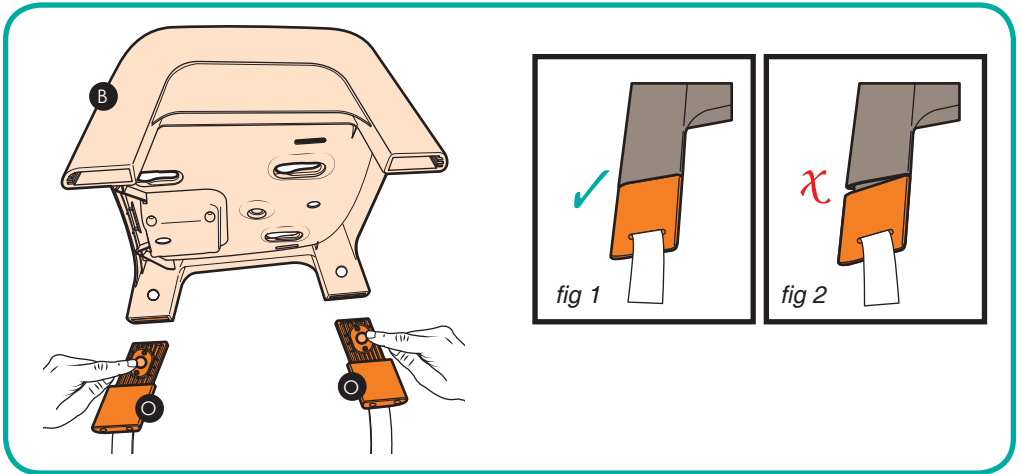

1. Press in button (i) and slide the booster-seat feet (O) into the sockets on the seat base (B), ensuring each foot 'clicks' into place. Attach all four feet and check that they are all properly connected.

**IMPORTANT:** Check that the assembled feet and seat base resemble (fig 1) when viewed from the side and NOT (fig 2).

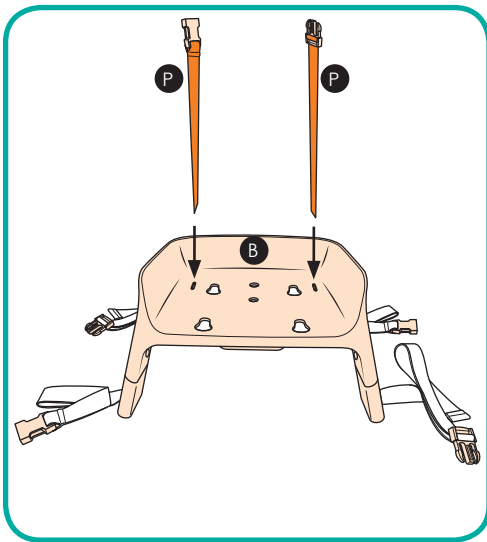

2. Feed the two ends of the backrest strap (P) through the harness slots in the seat base (B)

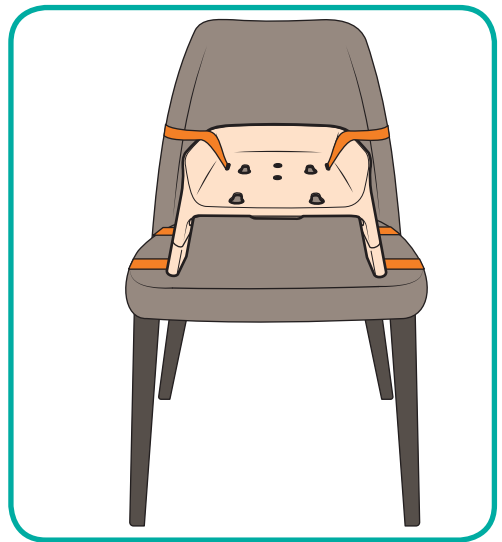

3. Place the partly assembled booster seat on a suitable adult chair.

## Assembling the booster seat (continued)

4. Wrap all four "foot-straps" under the adult chair and buckle them together **ENSURING** you **DO NOT** cross the straps. Wrap the backrest strap around the back of the adult chair and buckle it together. Pull and tighten all straps to prevent as much movement as possible. If the booster seat moves around too easily then it may not be suitable for use on the adult chair and you should find a better suited adult chair.

**WARNING! DO NOT** place anything under the booster seat and on the adult chair such as cushions or fabrics as they may cause the booster seat to become unstable.

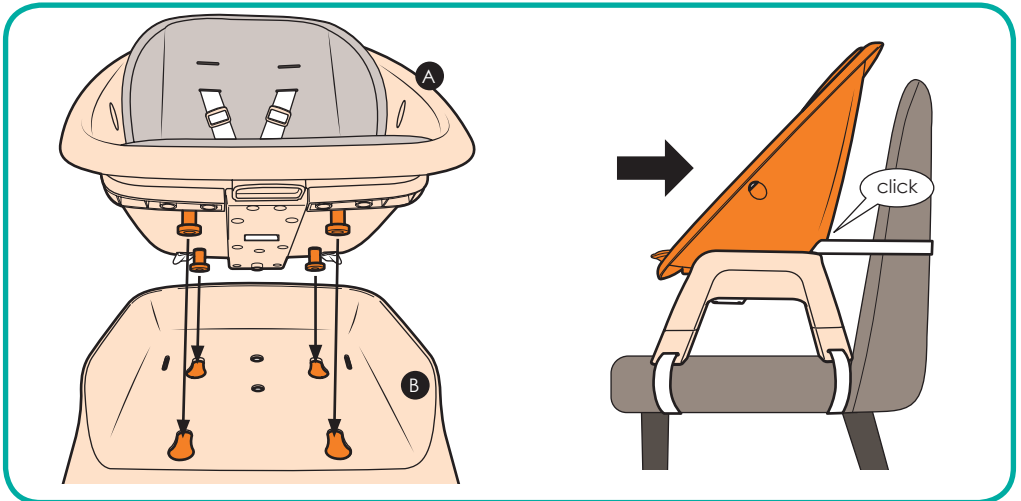
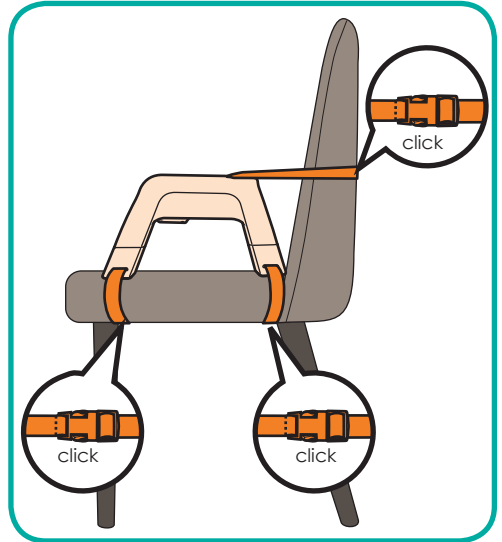

5. Insert the four pins on the underside of the seat shell (A) into the four keyhole slots on the upper surface of the seat base (B) and push the seat shell back into the seat base to lock the four pins in place.

## Assembling the booster seat (continued)

6. Finally secure the seat shell (A) to the seat base (B) using the seat-lock screw (H).

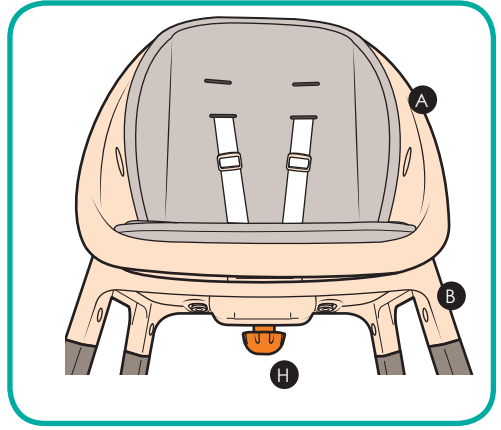

## Care and maintenance

- Avoid placing the highchair in direct sunlight for extended periods. Over time this will cause the materials and finish to fade.
- Clean the seat fabric using either a dry or damp cloth. Do not soak the seat fabric or attempt to wash by hand or by machine.
- **DO NOT** Iron or expose the seat fabric to strong heat.
- The top food tray can be placed in a dishwasher or washed by hand using a mild detergent.
- The bottom food tray is **NOT** dishwasher safe. It should be wiped clean only, using a damp cloth and mild disinfectant.
- The highchair frame can be cleaned using a damp cloth with warm water and a mild detergent.
- A mild disinfectant can be used if desired. Stubborn marks maybe removed with a NON-abrasive cleaner.
- The highchair must be dried thoroughly before using or storing.
- NEVER clean any part of the highchair with abrasive, ammonia based, bleach based or spirit type cleaners.



[www.mychild.co.uk](http://www.mychild.co.uk)

Customerservice@kooltrade.co.uk  
Imported by Kooltrade Ltd. M34 3QA  
Tel: 0161 335 2508