

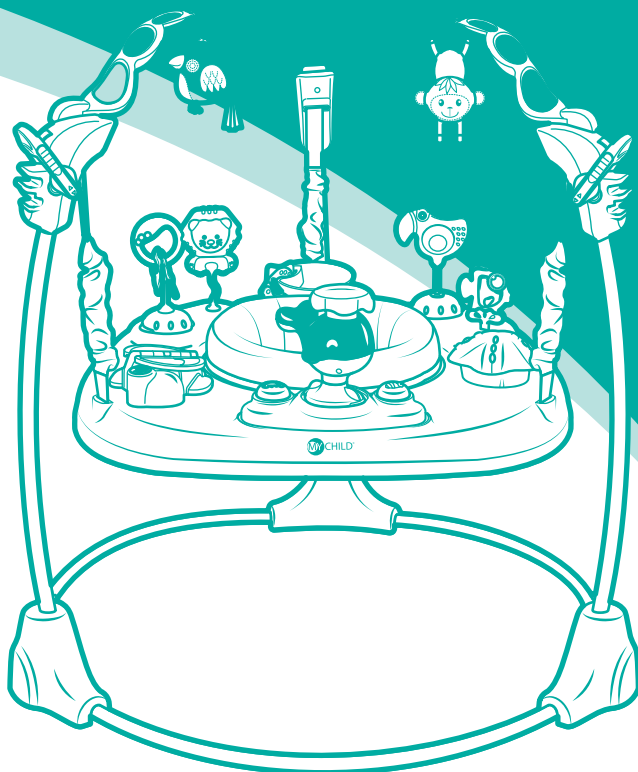

Animal Kingdom Jumpabout Instruction manual



INSTRUCTIONS: IMPORTANT! KEEP FOR FUTURE REFERENCE.

The child may be hurt if you do not follow these instructions.

The baby bouncer is for a child able to support its head unaided up to a maximum weight of 12kg (approx. 36 months)

Safety instructions



Warning: Adult assembly required.

Warning: Not to be used by children over 36 months. Due to insufficient strength.

Warning: Use this product only if your child meets all of the following conditions:

- Your child is at least 4 months old and less than 36 months old.
- Your child can support its head unaided.
- Your child is less than 76.2cm tall.
- Your child weighs less than 12kg.

Warning: NEVER LEAVE THE CHILD UNATTENDED!

Warning: DO NOT USE THE BABY BOUNCER AS A SWING!

Warning: DO NOT place children who can stand or walk on their own in the activity centre.

Warning: NEVER use near stairs or in other dangerous conditions or situations.

Warning: NEVER move the baby bouncer while the child is in the seat.

Warning: DO NOT adjust height while child is sitting in the product.

Warning: It can be dangerous to allow other children to play near the baby bouncer.

Warning: Strings can cause strangulation! **DO NOT** place items with string around child's neck, such as hood strings or dummy cords. **DO NOT** suspend string over the product or attach strings to toys or place near curtain blinds cords or other hanging cords. Do not add any strings or straps to any part of the baby bouncer.

DO NOT use the baby bouncer if it is damaged or broken.

Make sure all leg posts are securely fastened before putting child in the seat. Check to ensure they are secure before each use.

Make sure baby bouncer legs are securely locked in position on a flat surface before putting your child in the seat.

Ensure that the child is correctly and safely positioned in the seat of the baby bouncer.

Only replacement parts supplied by the manufacturer should be used on the product.

Recommended time limit per use session is 20 minutes.

Important: Care should be taken in unpacking and assembly.

Important: Examine product frequently for damaged, missing, or loose parts.

Battery warnings

Only use the recommended batteries observing correct voltage and size.

Always take care to insert your batteries correctly, observing the plus and minus marks on the battery and appliance.

Do not mix new and used batteries.

Do not mix different types of batteries.

Always remove batteries (whether they are dead or not) if you are not going to use the product for long periods (as batteries may leak and cause damage).

Never attempt to re-charge ordinary (non-rechargeable) batteries.

Remove rechargeable batteries before attempting to charge them.

Do not short-circuit the supply terminals

Batteries should always be changed by an adult.

Keep batteries out of reach of children.

Children can choke on batteries. If swallowed seek medical advice immediately.

Battery disposal

The crossed out wheellie bin symbol indicates that the product must not be disposed of with other household waste. Do not treat batteries (old or new) as household waste. Never dispose of batteries in a fire this may cause them to explode. Batteries (old or new) should be disposed of by taking them to a designated collection point or recycling facility.



Your 3 year warranty

Whilst we make and test our products to the highest standards of durability there's always a small chance of a hiccup! Our promise is to repair, replace or refund a MyChild product that has an identified manufacturing defect from the date of purchase for a full 3 years thereafter at no extra cost.

However, you must register within 28 days of the date of purchase to receive the full 3 years guarantee!

To receive your full guarantee you can register your product by: visiting www.mychild.co.uk/warranty.html and complete the warranty form, or by telephone on 0161 335 2508.

Welcome

Thank you for purchasing the MyChild Animal Kingdom Jumpabout. Please read the instructions and warnings carefully before use to ensure safe and satisfactory operation of this product.

Your child's safety is your responsibility. If you have a query with this product or require replacement parts, please contact the MyChild Helpline on 0161 335 2508.

Lay out the parts on a soft level surface and compare to the part/fixings checklist below. Do not discard any packaging until you are sure that you have all the parts.

WARNING! Assembly by an adult. Keep away from children until fully assembled. Keep children clear during assembly as pack contains small parts which may present a choking hazard.

Parts checklist

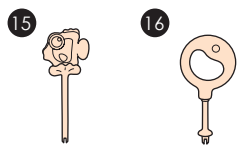
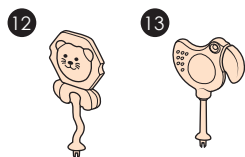
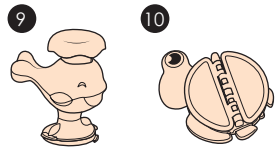
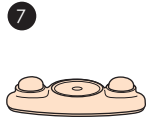
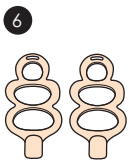
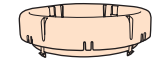
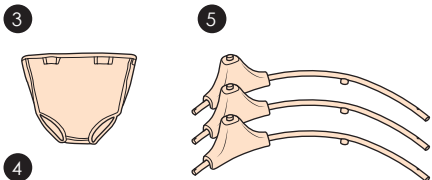
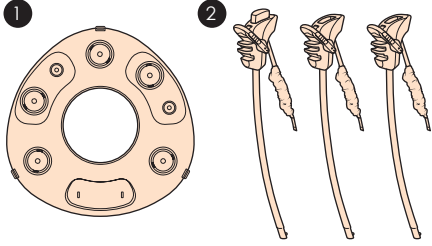

Contained in your carton are:

Nº	Part	Qty
1	Platform	1
2	Legs	3
3	Seat fabric	1
4	Seat unit	1
5	Feet and tubing	3
6	Toy hangers	2
7	Toy tray	1
8	Toy bases	2
9	Whale toy	1
10	Sea turtle toy	1
11	Starfish toy	1
12	Lion toy	1
13	Toucan toy	1
14	Feeding bowl	1
15	Fish teether	1
16	Bubble toy	1
17	Teethers	4
18	Monkey soft toy	1
19	Bird softy toy	1

You will require one Phillips screwdriver (not supplied).

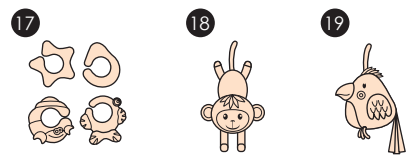

Detach the seat unit from the platform

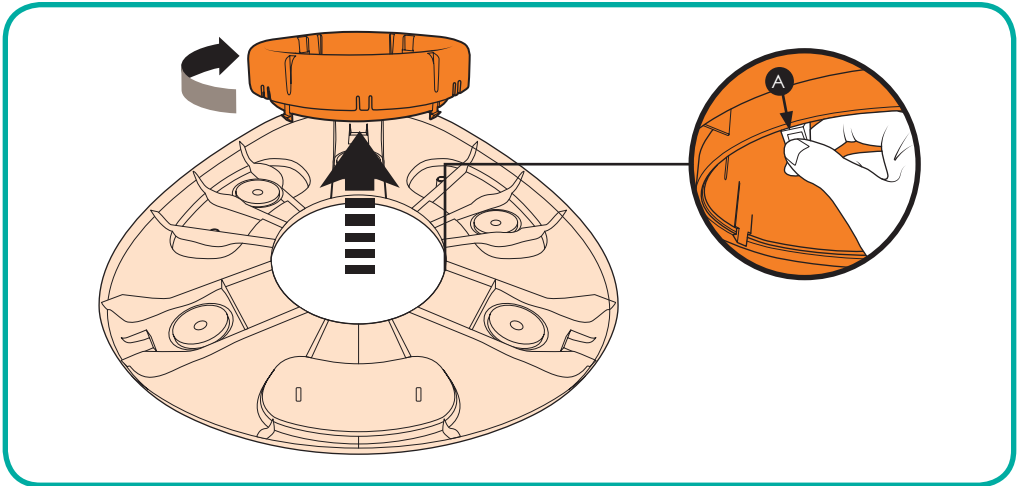

1. Press the clips (A) on the underside of the seat unit whilst lifting and rotating the seat unit.

Foot-ring assembly

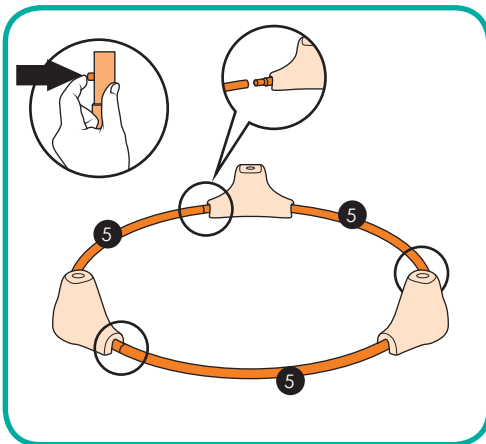

1. Join all the feet and tubing parts (5) to form foot-ring assembly pushing the narrow end of one tube into the wider opening end of the neighbouring tube.

Ensure all locking pins “click” and lock into place.

Leg assembly

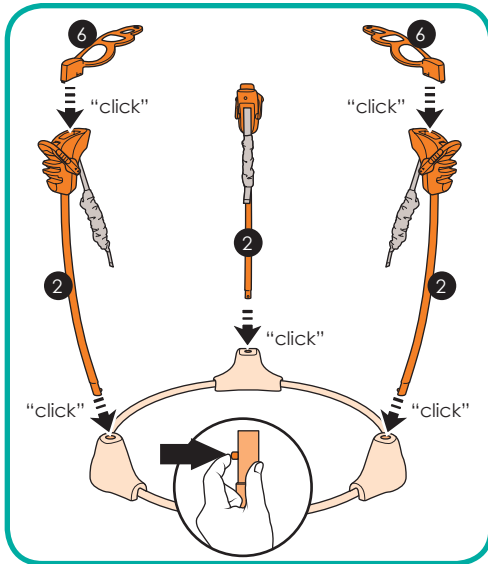

1. Attach the two toy hangers (6) to two of the legs (2) as shown.

Push the end of each leg (2) into openings on the plastic feet of the foot-ring assembly.

Ensure all locking pins "click" and lock into place.

IMPORTANT! Pull up on each leg to check they are securely fixed to the foot-ring.

Platform assembly

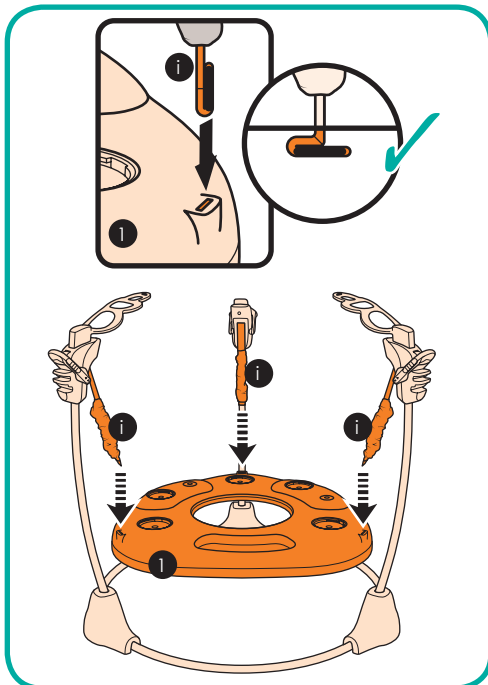

1. Insert each of the three strap (i) into the slots on the platform (1).

IMPORTANT! Pull up on each strap to ensure that the anchors are set securely on the underside of the platform.

Seat unit assembly

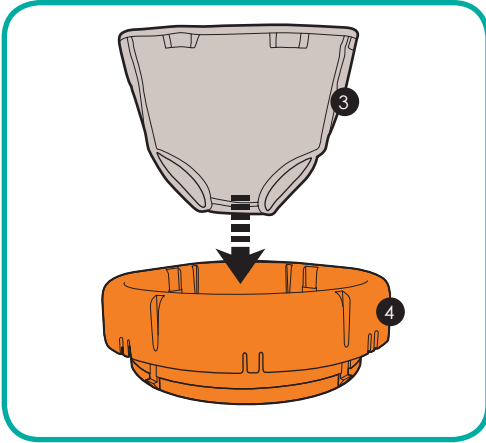

1. Place the seat fabric (3) into the seat unit (4).

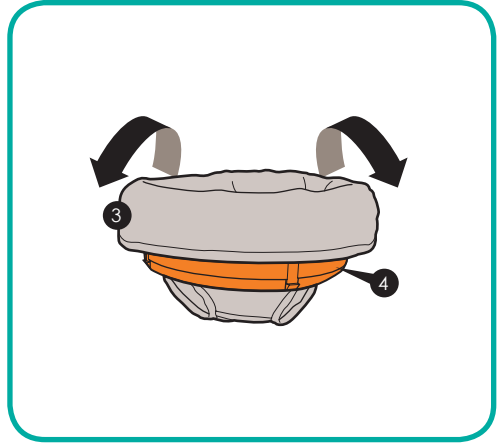

2. Fold the seat fabric (3) over the seat unit (4).

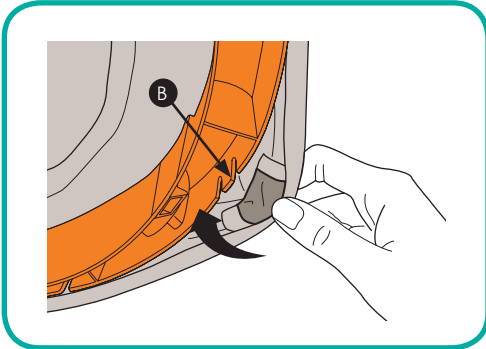

3. Hook the 8 webbing strips on the underside of the seat fabric over the tabs (B) on the seat unit.

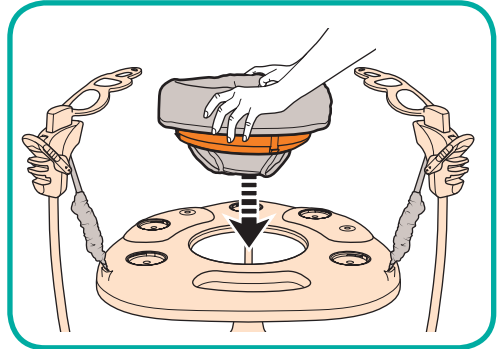

4. Insert the assembled seat unit into the seat tray, pressing it down until it 'clicks' into place.

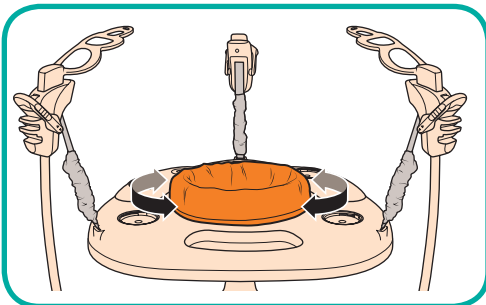

5. Check the seat unit is able to rotate fully.

ATTENTION: Children can play inside the baby bouncer ONLY when it is fully assembled.

Toy tray assembly

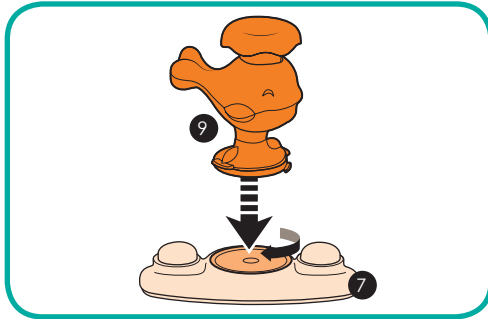

1. Insert the whale toy (9) into the socket located on the toy tray (7) top and turn the whale toy clockwise to lock it in position.

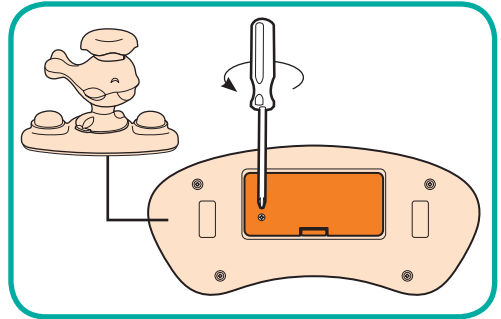

2. Using a Phillips screwdriver, unscrew the battery cover on the underside of the play tray.

WARNING: Assembly by an adult.

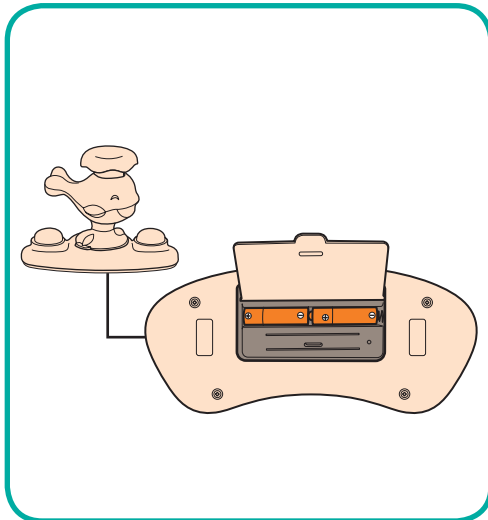

3. Insert 2 x 1.5V AA batteries (not supplied) ensuring the correct battery orientation is observed and then reattach the cover, replacing the screw making sure it is not over tightened.

ATTENTION: Refer to 'Battery warnings' on page 2.

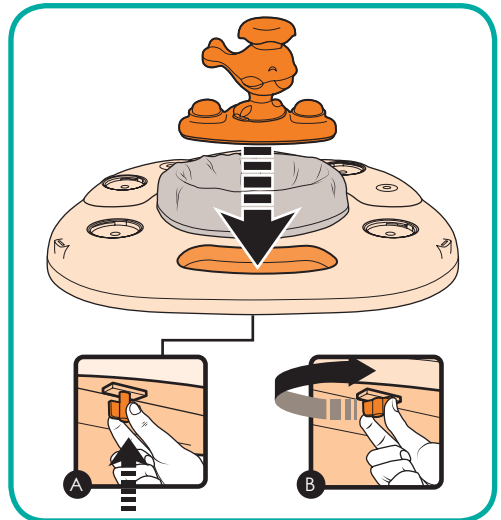

4. Place the toy tray into the large recess at the front of the bouncer platform.

On the underside of the platform, push the two plastic tabs up and rotate clockwise to lock the toy tray in place.

Toy assembly

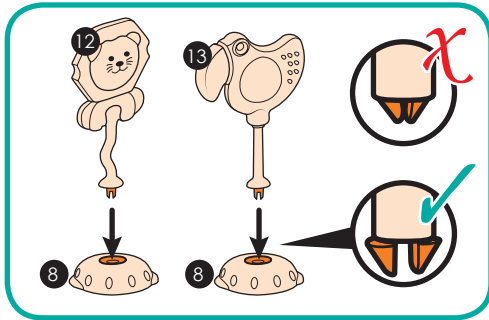

1. Push the ends of toys (12) and (13) into the holes in the centre of the toy bases (8). Pull up on the toy stems to check they are secured to the toy bases properly.

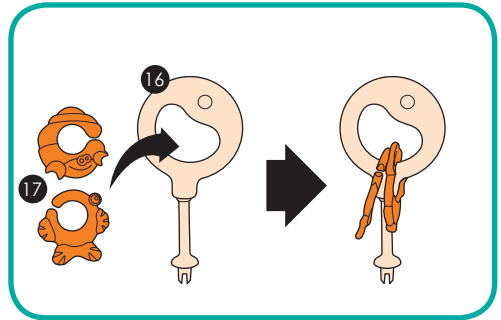

2. Hook two of the teethers (17) on to the bubble toy (16)

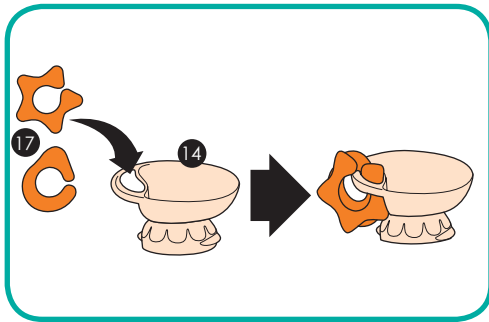

3. Hook the remaining two teethers (17) on to feeding bowl (14)

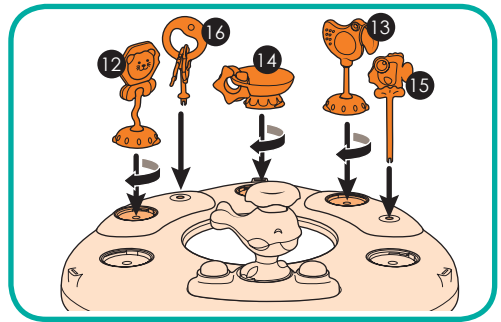

4. Push the ends of the bubble toy (16) and fish toy (15) into the holes on the platform. Insert the lion toy (12), toucan toy (13) and feeding bowl (14) into the recesses on the platform and rotate them clockwise to lock in place.

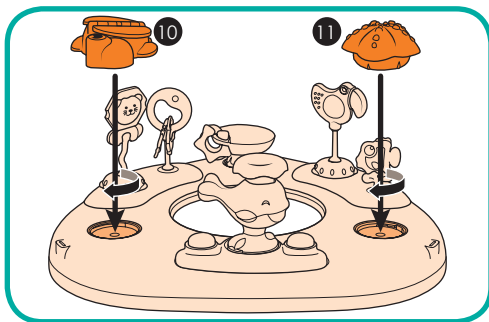

5. Insert the sea turtle toy (10) and starfish toy (11) into the remaining two recesses at the front of the platform and rotate them clockwise to lock in place.

Note: Toys 10, 11, 12, 13 and 14 are interchangeable and can be moved as desired.

Soft toy assembly

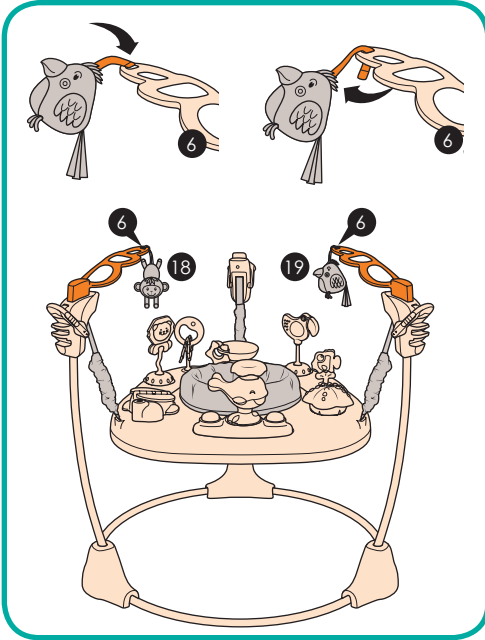

1. Attach the two soft toys (18) and (19) to the hangers (6) using the Velcro tabs

Height adjustment

WARNING! DO NOT adjust the height with a child seated in the bouncer. Always remove the child before making any height adjustment.

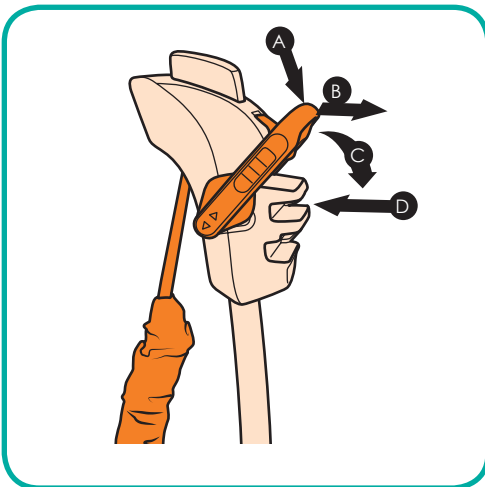

(A) Press the latch downwards.

(B) Pull the latch outwards to disengage it from the locking mechanism.

(C) Move the latch up or down to one of the three height positions.

(D) Push the latch back into the locking mechanism.

Repeat as necessary, **ENSURING** all three legs are set at the same height before using the bouncer.

Care and maintenance

- To prolong the life of your nursery product keep it clean and do not leave it in direct sunlight for extended periods of time.
- Plastic parts can be wiped clean with a damp cloth and mild soap then allowed to air dry.
- **DO NOT** immerse plastic parts in water.
- Clean toys before use. **NOT** dishwasher safe.
- Removable fabric covers and trims may be cleaned using a damp sponge with soap or mild detergent. Allow it to dry completely before folding or storing it away.
- Do not dry clean, or use bleach.
- In some climates the covers and trims may be affected by mould and mildew. To help prevent this occurring, do not fold or store the product if it is damp or wet. Always store the product in a well ventilated area.
- Always check parts regularly for tightness of screws, nuts and other fasteners - tighten if required. To maintain the safety of your nursery product, seek prompt repairs for bent, torn, worn or broken parts.
- Do not use the product if any components are broken or missing
- Regularly clean parts that have been mouthed by your child.



www.mychild.co.uk

Customerservice@kooltrade.co.uk
Imported by Kooltrade Ltd. M34 3QA
Tel: 0161 335 2508